

NF30G-L/NF30GW-L(조광형)

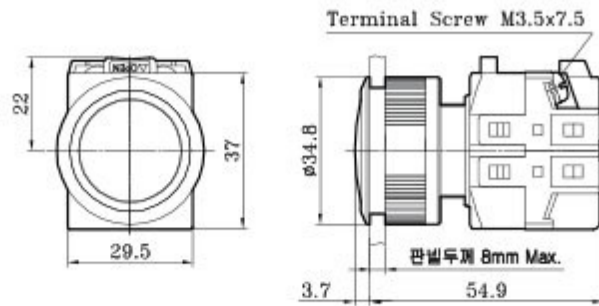

NF30G-S/NF30GW-S(비조광형)

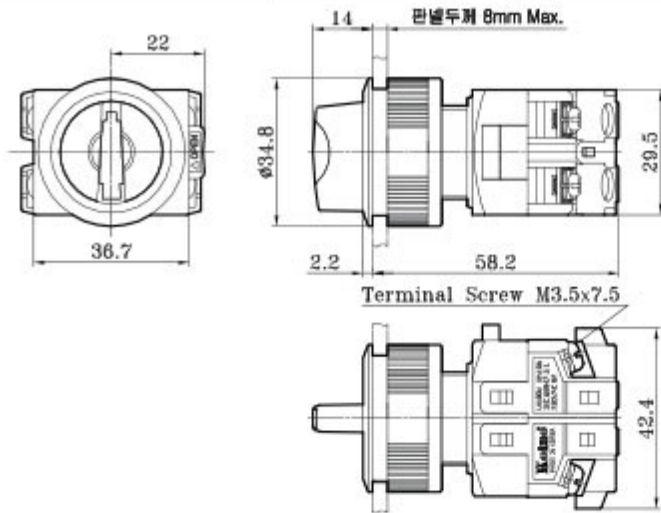

NF30G-P/NF30GW-P(비조광형)

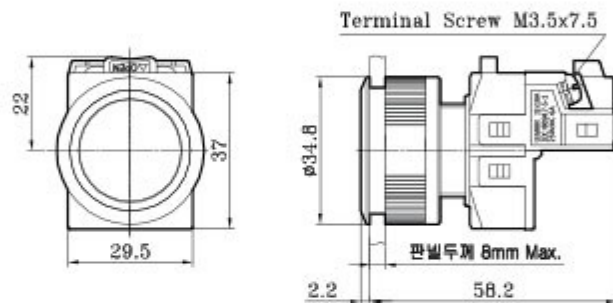

NF30G-S/NF30GW-S(조광형)

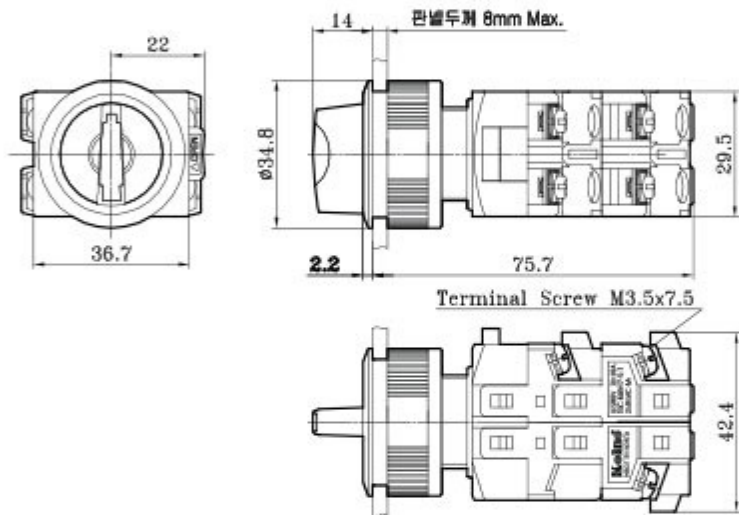

NF30G-B/NF30GW-B(조광형)

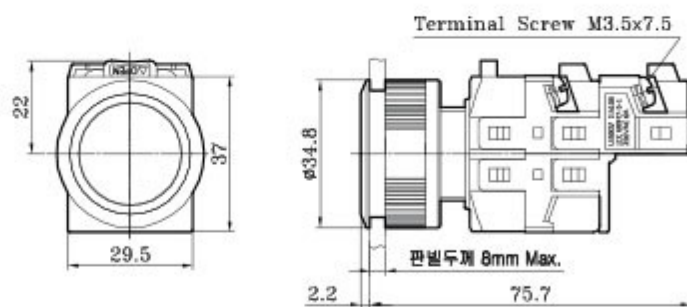

NF30G-K/NF30GW-K(비조광형)

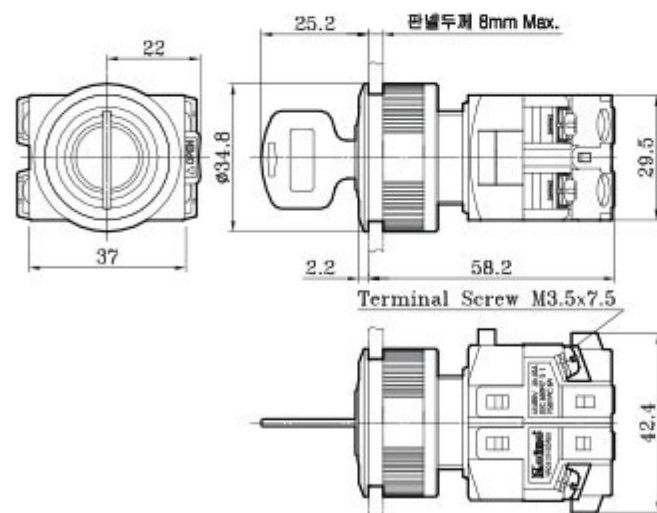

NF30-S, NF30-K(조작범위)

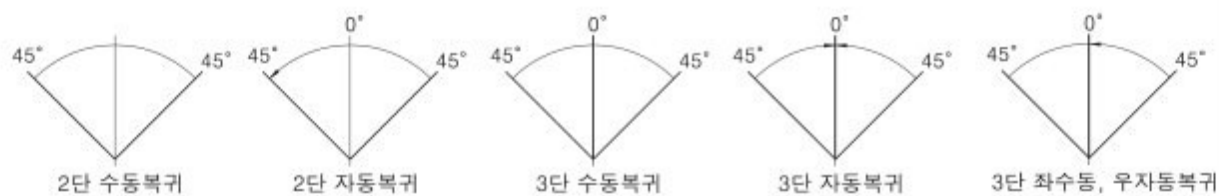

판넬가공치수

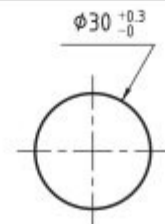

Panel Cut Size